

7115 78th Ave SE, Mercer Island, WA

Client Name:

Peter Davis Builders

Inspection Date:

6/10/2019

Access Code:

guep

Report #:

190610A

Inspector:

Breven Zahn

Seattle Sewer Inspection

(206) 335-2315

<http://seattlesewerinspection.com/>

seattlesewerinspection@gmail.com

Visit <http://videos.seattlesewerinspection.com/cabjagbaguep> to view a video of your sewer inspection.

Videos are typically available within 24 hours of the inspection!

Sewer Inspection Report

Description

Inspected the line from the catch basin in the driveway, towards the street. 6" PVC pipe. Reached the second catch basin at 79' (2'10" deep). Inspected the line from the second catch basin (in the side wooded area). 6" PVC pipe. Reached the third catch basin at 46'6" (3'7" deep). Inspected the line from the third catch basin (in the side/rear wooded area). 6" PVC pipe. The line runs onto the western neighbor's property at 50' (3'7" below the western fence). Reached the fourth catch basin at 118'. Inspected the line from the fourth catch basin (4'4" below the driveway to 7036 W Mercer Way). 6" PVC pipe. Reached the fifth catch basin at 126' (5'5" below the side of W Mercer Way). No other portion of pipe or connecting lines were inspected.

Observations

FIRST CATCH BASIN:

25'= 4'9" deep
50'= 2'7" deep
79'= 2'10" deep at CB 2

CATCH BASIN 2:

25'= 4'1" deep
46'6"= 3'7" deep at CB 3

CATCH BASIN 3:

25'= 3'8" deep
50'= 3'7" deep, under west fence
118'= 4'4" deep, at CB 4, under neighbor's driveway

CATCH BASIN 4:

25'= 4'2" below the neighbor's driveway
50'= 4'2" below the neighbor's driveway

75'= 4'3" below the neighbor's driveway

126'= 5'5" below the bottom of the neighbor's driveway/side of W Mercer Way

There is good slope throughout the system.

There are no cracks or 'breaks' seen at this time.

Visit <http://videos.seattlesewerinspection.com/cabjagbaguep> to view a video of your sewer inspection.

Videos are typically available within 24 hours of the inspection!

017-470 420

MERCER ISLAND SEWER DISTRICT

SIDE SEWER PLAT

PERMIT No. 7319-E

Owner Kenneth Schorz

Address 7115 & 78th AVE SE

Contractor Rusch Constructing

Date Permit Issued 12-30-87

Date Job Completed and Accepted 1-6-88

By Hart

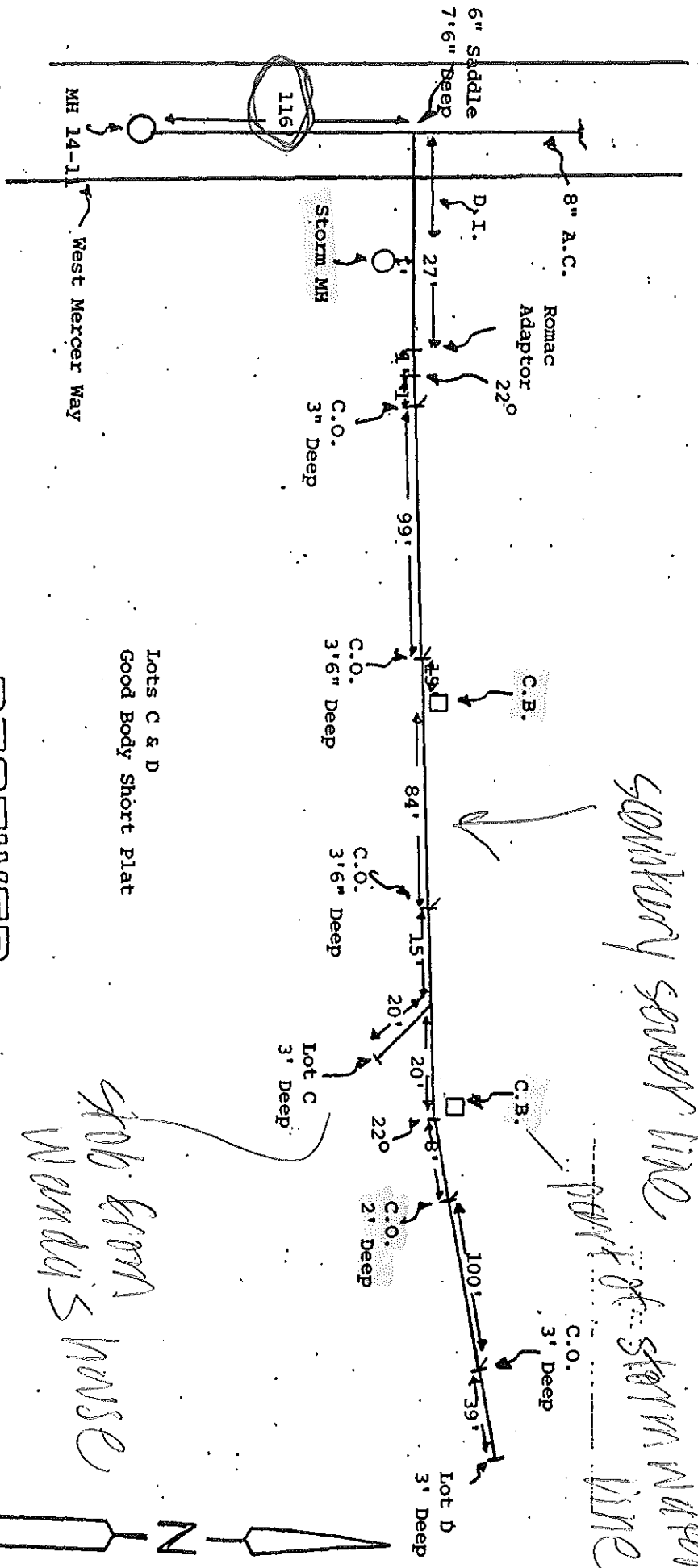

sanitary sewer line
part of storm water line

job from
Wanda's house

Lots C & D
 Good Body Short Plat

RECEIVED

JAN 12 1988

CITY OF MERCER ISLAND
 UTILITY DEPT.

1. Type of Pipe D.I. & PVC Size 6"
2. New manhole number nearest downstream manhole 14-11
3. Old manhole number nearest downstream manhole _____
4. Map Number _____ Number of dwelling units _____
5. Remarks _____

1. Name _____
2. Type _____
3. Frontage _____
4. No. of Floors _____
5. Remarks _____

COMMERCIAL ONLY

